

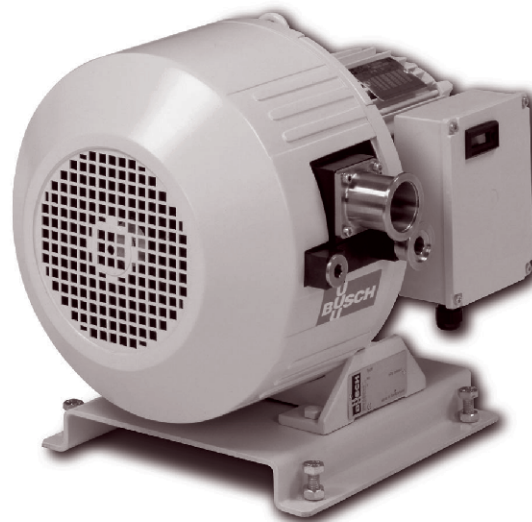

Fossa

FO 0018 C - FO 0030 B



FO 0030 B

Description

Fossa scroll vacuum pumps feature a non-contacting scroll design that reaches high vacuum and suction capacity at lower power consumption.

As a dry-running vacuum pump, no sealing or lubricating oil is needed in the pumping chamber. With a low-maintenance design and reduced power requirements, Fossa scroll vacuum pumps have minimal operating costs.

Features

- Non-contacting design with no wear in the pumping chamber
- Dry-running
- Low maintenance requirements
- Air-cooled, requiring no water
- Compact and lightweight design allows for easy transport
- Low vibration and noise levels
- No nitrogen purge gas required

Standard Equipment

- DN style vacuum connections for inlet and outlet
- Hour meter
- TEFC motor
- Base frame with adjustment screws

Scroll vacuum pumps

Operating Principle

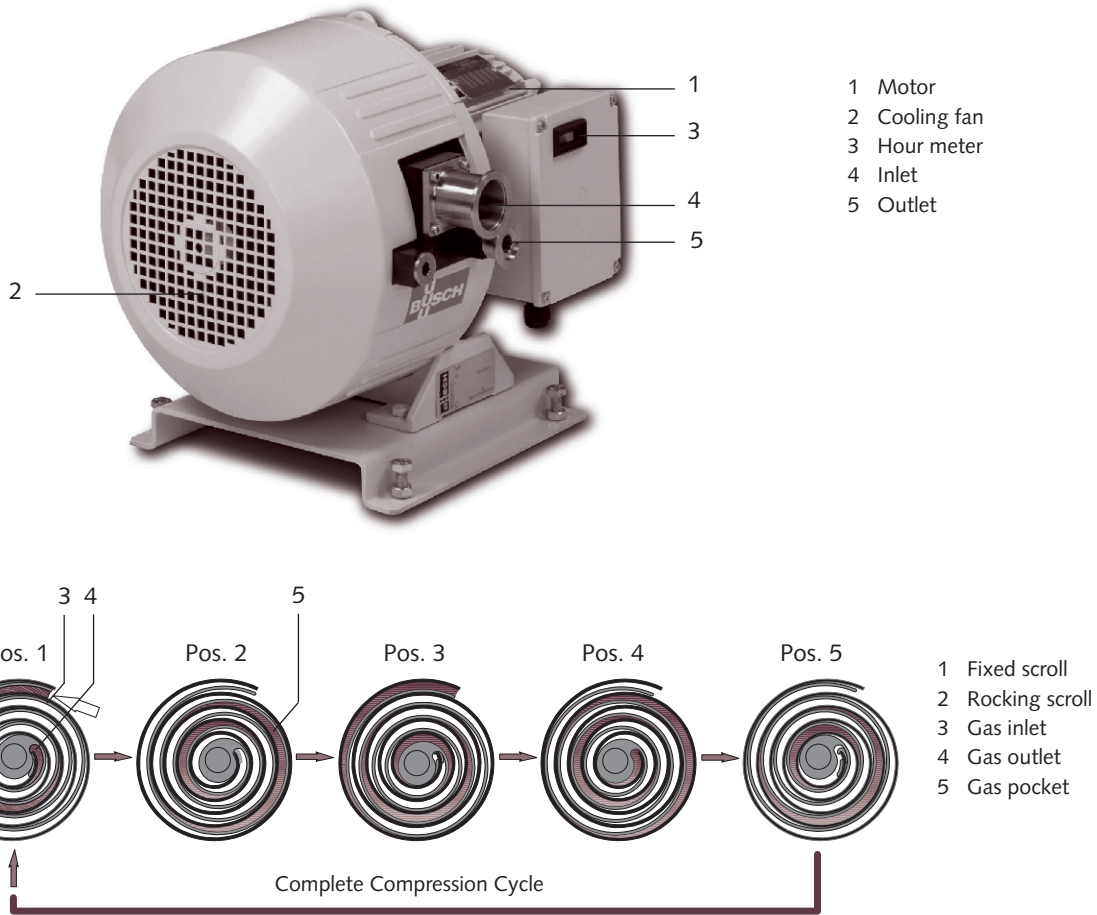

Operating Principle

The Fossa scroll vacuum pump consists of a fixed scroll and an orbiting scroll which mesh to form successive crescent shaped volumes.

The orbiting action of the driven scroll continuously compresses the crescent shaped gas pockets and transfers them to the center of the pump to be discharged through the outlet port.

Accessories

- Inlet filters
- Gauges
- Fittings
- Check valves

Applications

- Load lock/Transfer
- Helium leak detection
- Laboratory applications
- Analytical devices
- Mass spectrometers
- Dry and clean vacuum systems
- Microscopy



Technical Data

Pumping Speed vs. Inlet Pressure

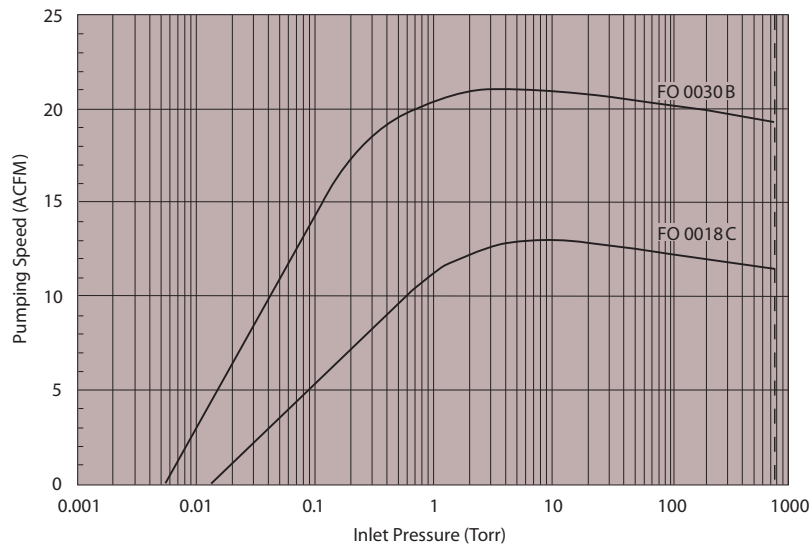

Technical Data		FO 0018 C	FO 0030 B
Nominal pumping speed*	ACFM	13	21
Ultimate pressure	Torr	.013	.0056
Motor size	kW (Hp)	0.37 (0.5)	0.6 (0.8)
Motor rotational speed	RPM	1800	1800
Sound rating**	dB(A)	59	60
Approximate weight	Lbs.	81	84

*Performance data based on ambient conditions of 14.7 PSIA and 70° F, and have a tolerance of +/- 10%.

**DIN EN ISO 2151



Dimensions

FO 0018 C

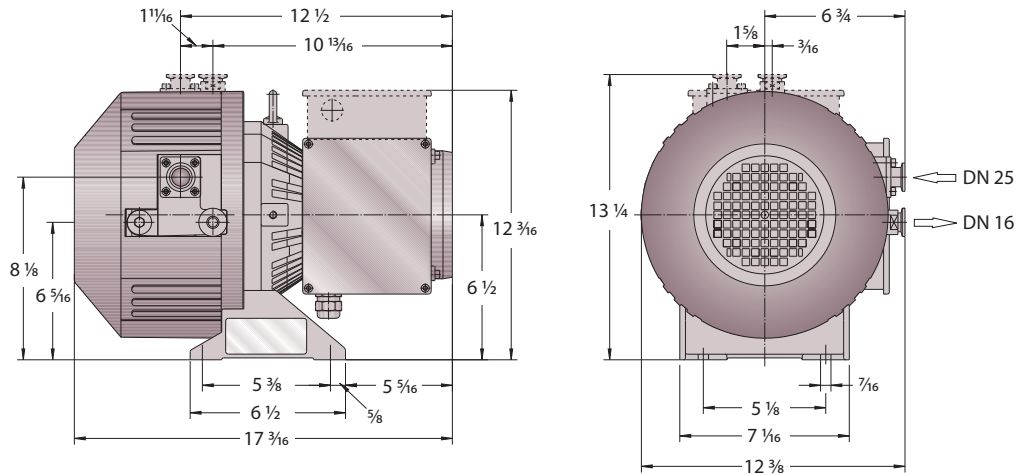

FO 0030 B

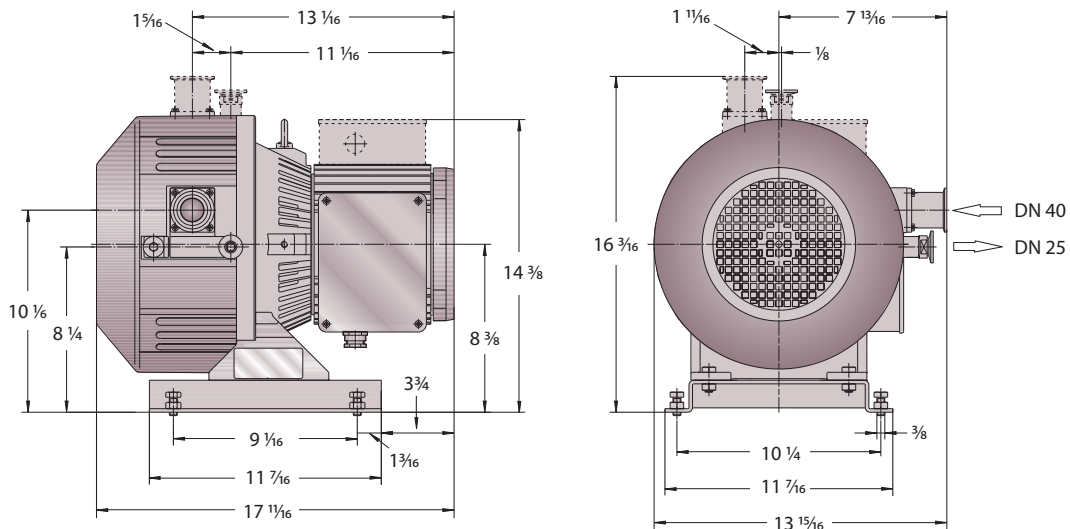

All dimensions in inches unless otherwise noted.

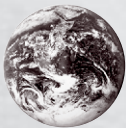

Busch - all over the world in industry

ISO 9001 Registered Company

**Busch LLC 516 Viking Drive Virginia Beach, VA 23452
Phone (757) 463-7800 Fax (757) 463-7407**

**www.buschusa.com
1-800-USA-PUMP**

Amsterdam Auckland Bangkok Barcelona Basel Birmingham Brno Brussels Budapest Buenos Aires Copenhagen Dubai Dublin Gothenborg Helsinki Istanbul Johannesburg Kuala Lumpur Maulburg Melbourne Milan Monterrey Montreal Moscow New York Oslo Paris Porto Pune Santiago de Chile São Paulo Seoul Shanghai Singapore Taipei Tel Aviv Tokyo Vienna Warsaw